

AT2-605

Differential pressure transmitter
605 for low ranges ATEX/IECEX Exd

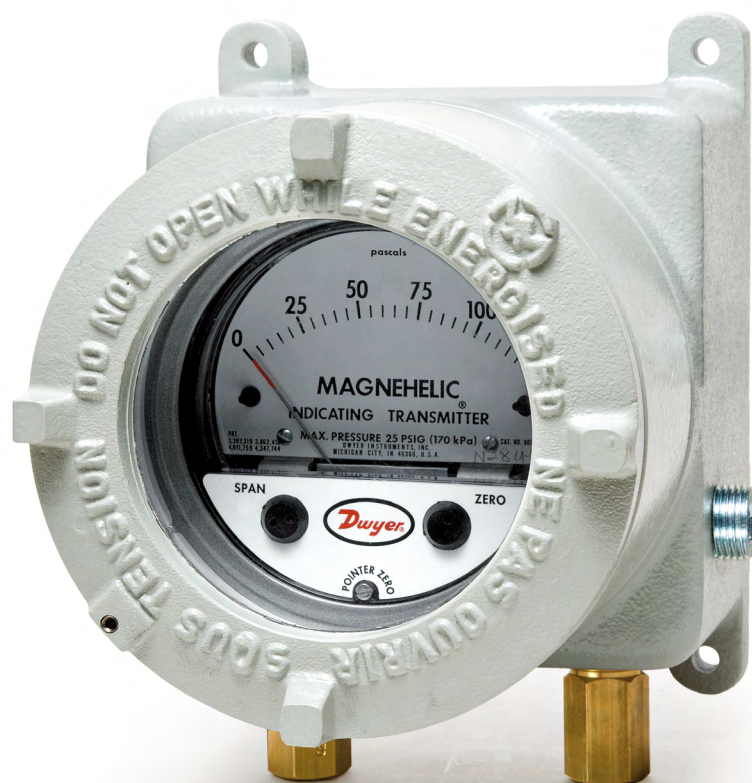

- Dwyer® 605 gage/transmitter now available from Comhas as single instrument ATEX/IECEX approved
- Local indicator of differential pressure
- Output 4-20 mA – 2 wire

| | |
|------------------|---|
| ATEX | CE 1370 II 2G Ex d IIC T6 Gb II 2D Ex tb IIIC T85°C Db, -60°C ≤ T _{amb} ≤ +60°C Certificate: BVI 14 ATEX 0072 |
| IECEX | Ex d IIC T6 Gb Ex tb IIIC T85°C Db Certificate: IECEX EPS 14.0082 |
| ENCLOSURE RATING | IP66 (IP65 with option OPV) |



AT2-605 SPECIFICATIONS

| | |
|-------------------------------|---|
| Service: | air and compatible clean and dry gases |
| Wetted parts: | consult factory |
| Accuracy: | see "standard table ranges" |
| Pressure limits: | see "standard table ranges". |
| Temperature limits: | 605 transmitter: from 20 to 120°F (-6.67 to 48.9°C) Case: from -76 to 140°F (-60 to 60°C)* |
| Dial size: | 4" (101.6 mm). |
| Mounting orientation: | Diaphragm in vertical position |
| Housing material: | aluminium (optional stainless steel). |
| Finishing: | texture epoxy coat RAL7038 (only aluminium enclosure). |
| Process connections: | 1/8" female NPT brass (stainless steel optional). In case of acetylene presence it is requested to use stainless steel. |
| Electrical wiring: | screw terminals. |
| Electrical connection: | 2 x 1/2" NPT F standard (supplied without cable gland). |
| Dimensions: | see drawing below. |
| Weight: | 5,7 Kg ab. |

TRANSMITTER SPECIFICATIONS

| | |
|---------------------------------------|---|
| Compensated temperature range: | from 32 to 120°F (0 a 48.9°C). |
| Thermal effect: | 0.045% f.s./°C. |
| Power requirements: | 10-35 Vdc (2-wires). |
| Output signal: | 4-20 mA. |
| Zero and span adjustment: | protected potentiometer on 605 face (can access those opening case allowed only in safe zone). |
| Loop resistance: | DC; 0-1250 ohms max. |
| Current consumption: | DC; 38 mA max. |
| Electrical connection: | screw terminal block. |

* Operating ambient temperature is defined also according to the options and pressure instrument choosed.

CAUTION FOR USE ONLY WITH AIR OR COMPATIBLE GASES!
CONTACT FACTORY FOR USE WITH GASES, OTHER THAN AIR AND NITROGEN.

IMPORTANT NOTES FOR INSTALLATION:

Cables must be fitted through 1/2" NPT cable gland or Atex/IECEX conduit (not supplied with instrument).

Make sure after cabling to close tight cover and cable gland, in order to keep IP66 rating
(IP65 with option OPV, pressure relief valve)

Open cover only after de-energising instrument

Attention: check local safety rules and warnings on unit and manual for a correct use of the instrument in hazardous area.



STANDARD RANGES (OTHER RANGES AVAILABLE)

| MODEL | INCH W.C. | PRESSURE MAX | ELECTRICAL ACCURACY ±% | MECHANICAL ACCURACY ±% | MODEL | INCH W.C. | PRESSURE MAX | ELECTRICAL ACCURACY ±% | MECHANICAL ACCURACY ±% |
|---------|-----------|-------------------|------------------------|------------------------|-----------|-----------|-------------------|------------------------|------------------------|
| 605-00N | 605-00N | 25 psi (1.7 bar) | 2 | 4 | 605-20 | 0-20.0 | 11 psi (75,8 kPa) | 0.5 | 2 |
| 605-11 | 605-11 | 25 psi (1.7 bar) | 2 | 3 | 605-30 | 0-30 | 11 psi (75,8 kPa) | 0.5 | 2 |
| 605-0 | 605-0 | 25 psi (1.7 bar) | 2 | 3 | 605-50 | 0-50 | 11 psi (75,8 kPa) | 0.5 | 2 |
| 605-1 | 605-1 | 25 psi (1.7 bar) | 2 | 2 | MODEL | PA | | | |
| 605-2 | 605-2 | 2 psi (13,79 kPa) | 0.5 | 2 | 605-60PA | 0-60 | 25 psi (1.7 bar) | 2 | 4 |
| 605-3 | 605-3 | 2 psi (13,79 kPa) | 0.5 | 2 | 605-125PA | 0-125 | 25 psi (1.7 bar) | 2 | 3 |
| 605-6 | 605-6 | 2 psi (13,79 kPa) | 0.5 | 2 | 605-250PA | 0-250 | 25 psi (1.7 bar) | 2 | 2 |
| 605-10 | 605-10 | 2 psi (13,79 kPa) | 0.5 | 2 | 605-500PA | 0-500 | 2 psi (13,79 kPa) | 0.5 | 2 |

DIMENSIONS

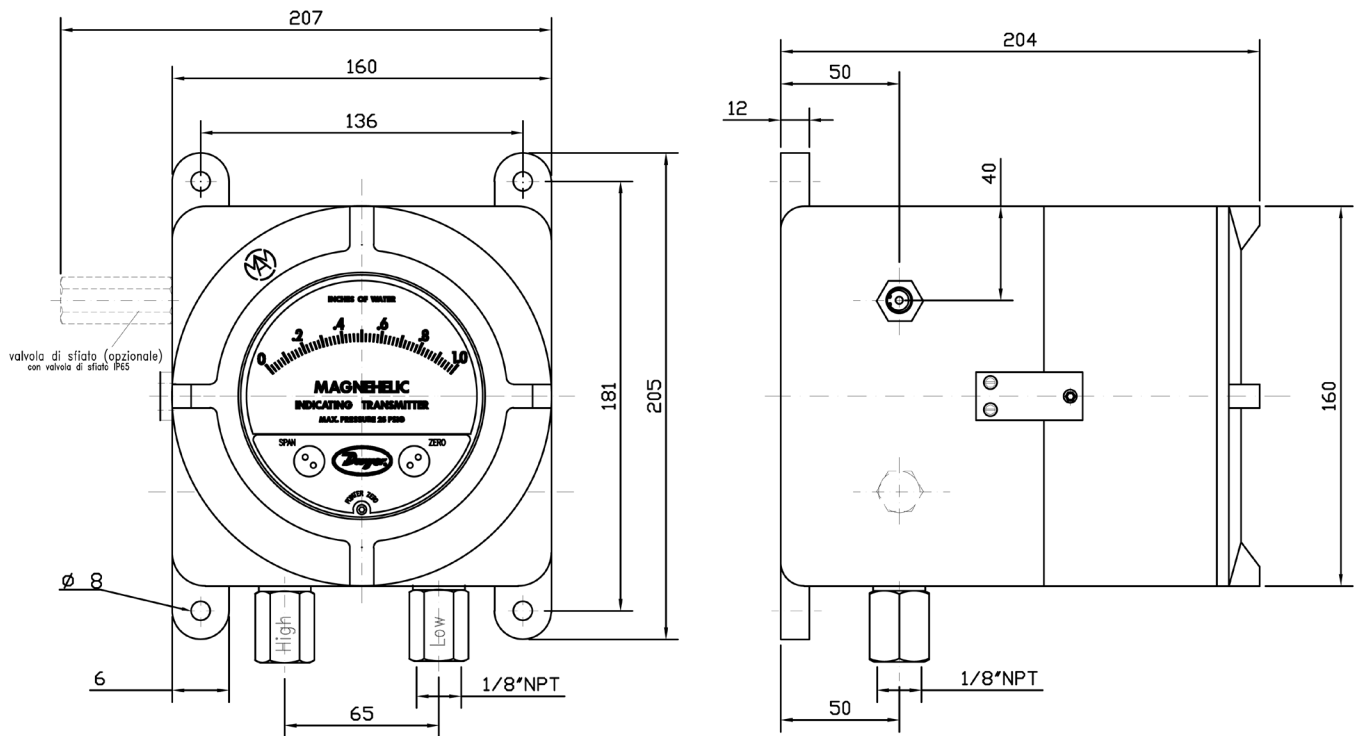

Consult factory for different holes layout.

| CODE | AT2 | - | 605 | - | | - | | - | | | | | | | | | |
|-----------------|---|-----------------------|-----|---|-------|----|---|---|--|--|---|--|--|---|-----|----|--|
| Housing | | | 605 | | | | | | | | | | | | | | |
| Ranges | .05-0-.20 inch W.C. | | | | 00N | | | | | | | | | | | | |
| | .25-0-.25 inch W.C. | | | | 11 | | | | | | | | | | | | |
| | 0-.50 inch W.C. | | | | 0 | | | | | | | | | | | | |
| | 0-1.0 inch W.C. | | | | 1 | | | | | | | | | | | | |
| | 0-2.0 inch W.C. | | | | 2 | | | | | | | | | | | | |
| | 0-3.0 inch W.C. | | | | 3 | | | | | | | | | | | | |
| | 0-6.0 inch W.C. | | | | 6 | | | | | | | | | | | | |
| | 0-10 inch W.C. | | | | 10 | | | | | | | | | | | | |
| | 0-20.0 | | | | 20 | | | | | | | | | | | | |
| | 0-30 inch W.C. | | | | 30 | | | | | | | | | | | | |
| | 0-50 inch W.C. | | | | 50 | | | | | | | | | | | | |
| | 0-60 Pa | | | | 60PA | | | | | | | | | | | | |
| | 0-125 Pa | | | | 125PA | | | | | | | | | | | | |
| | 0-250 Pa | | | | 250PA | | | | | | | | | | | | |
| | 0-500 Pa | | | | 500PA | | | | | | | | | | | | |
| | Not standard ranges | | | | xxx | | | | | | | | | | | | |
| | Option | Standard construction | | | | | X | | | | | | | | | | |
| Silicon free | | | | | | SF | | | | | | | | | | | |
| Case material | Alluminium | | | | | | | A | | | | | | | | | |
| | Stainless steel (s.s. connection included) | | | | | | | S | | | | | | | | | |
| Housing options | Blind top cover | | | | | | | B | | | | | | | | | |
| | Glass transparent cover | | | | | | | O | | | | | | | | | |
| | 1/8" NPT F brass pressure port | | | | | | | | | | 1 | | | | | | |
| | 1/8" NPT F stainless steel (only for aluminium housing) | | | | | | | | | | 2 | | | | | | |
| | Standard - without overpressure relief valve | | | | | | | | | | | | | X | | | |
| | Overpressure relief valve* (material: same as pressure ports) | | | | | | | | | | | | | | OPV | | |
| | Stainless steel tag | | | | | | | | | | | | | | | T2 | |
| Other options | See "other options" - Possible more than one option | | | | | | | | | | | | | | | | |

OTHER OPTIONS
XXXXX: Layout code for different holes sizes and layout.

Dimensions may change without any advice.